

# Tianjin Yolin Technology Co.,Ltd.

## Technical Specification

Product Name: DD-05 Side Stand Power Switch

Document Number:	YDD-20200416
Drawing Dumber:	DD05100Y01-V1.0
Version:	V1.0
Create Date:	2020-04-16
Modify Date:	
Prepared by:	Li Xiaoming
Checked by	Cao Ziheng
Confirmed by	

## Contents

1. General.....	1
2. Standard.....	1
3. General specifications.....	1
4. Product picture.....	2
5. Type test.....	2
6. Product dimension.....	3
7. Work principle.....	4
8. Considerations.....	4

## 1. General

In order to fully describe the technical specifications referred to in technical cooperation, a complete set of documents is usually required. As part of this specification, the technical specification for the Side stand power switch is binding on this type of component.

## 2. Standard

water proof test: GBT4208-2017

## 3. General specifications

Function and test items	Test method and condition description	Min.	Typ.	Max.	Unit
Operating Voltage	The normal operating voltage range of the sensor	4	5	6	V
Inverse Voltage	Maximum allowable inverse voltage value			-5	V
Operating Current				10	mA
Switch life	Number of work			100000	time
Working Temperature	The allowable operating temperature range of the product	-20	25	60	°C
OFF area voltage	When VCC=5V, OFF area voltage	4	5	6	V
ON area voltage	When VCC=5V, ON area voltage	0		0.2	V

## 4. Product picture



## 5. Type test

Items	Test Method	Test Result
Vibration	Under standard environment, the vibration table is fastened in a large plane direction, and the vibration table applies the vibration frequency at 33Hz and the acceleration is 1 G.The double amplitude is 1.5mm, the vibration direction is Z->X->Y, and the vibration direction is 2h.	All functions were normal after testing
High Temperature & Humidity Test	When the ambient temperature reaches $55 \pm 2^{\circ}\text{C}$ , the relative humidity is 90%-95%, it should continue to work normally for 2H.	All functions were normal after testing
High And low Temperature Aging Test	Test at $60^{\circ}\text{C}$ continuously for 24H $-20^{\circ}\text{C}$ continuous test for 24H	All functions were normal after testing
Drop Test	Free fall at 1 meter height for 3 times, Z->Y->X	All functions were normal after testing
Waterproof Test	Placed in the water tank under power off condition, the top end of the shell is required to be 100mm away from the water surface, the water depth is 1 meter, and the test is 30min	All functions were normal after testing
Durability test	Input voltage 5V, switching frequency 15~25 times/min, working cycle > 100000 times.	All functions were normal after testing

6. Product dimension

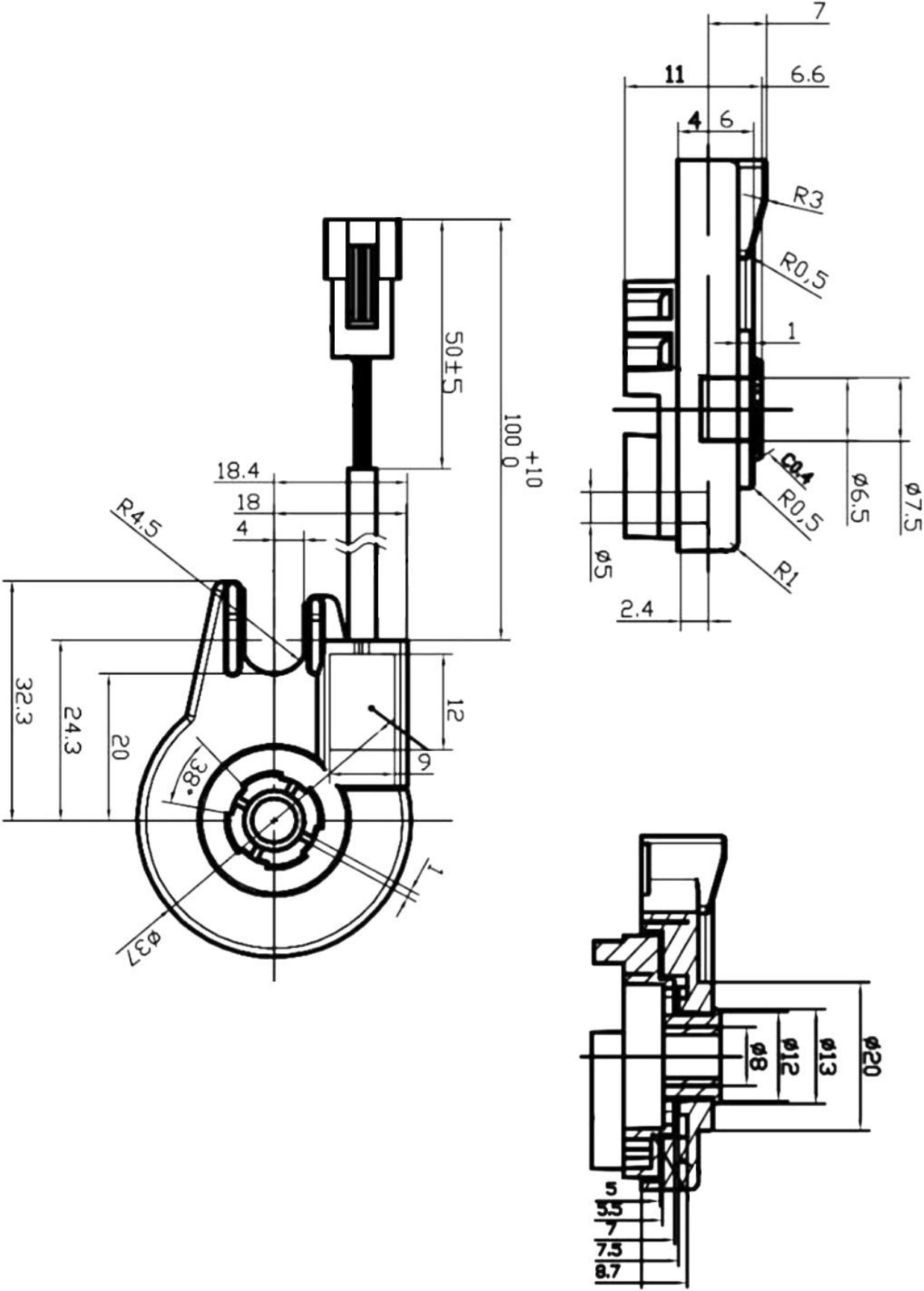

Appearance and dimensions (Unit: mm)

## 7. Work principle

Schematic diagram

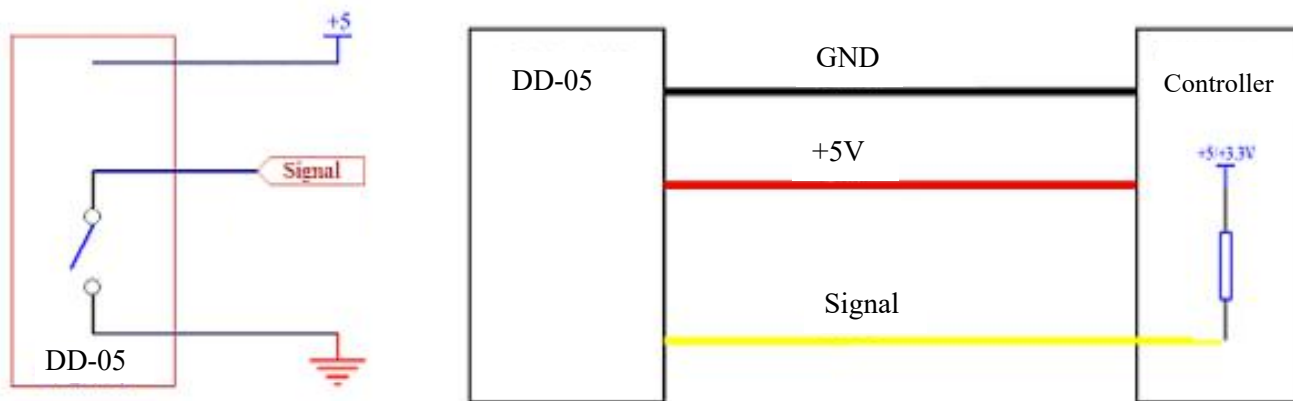

## 8. Considerations

1. Sensor leads are connected correctly and reliably without loosening.
2. Please handle the sensor gently. Do not use mechanical tools to press the sensor body during installation, otherwise the chip or component will be damaged and the function will be abnormal
3. Do not use mechanical tools to press the magnet area during installation, otherwise the magnet will be damaged and the signal will be abnormal
4. The power supply voltage of the sensor should be within a reasonable range, otherwise it will affect the normal operation of the sensor.
5. You should wear electrostatic bracelet during installation, otherwise it may cause damage to the components and affect the normal function.